



TabTimer
helping to keep people on time

Med-E-Lert™

EASY SET-UP

MANUAL



**AUTOMATIC
PILL DISPENSER**



TabTimer
helping to keep people on time

AUTOMATIC PILL DISPENSER

1 INSERT THE BATTERIES

Insert batteries into the Med-E-Lert™. The compartment is located on the back of the machine.



2 HOW TO OPEN

Open the compartment by pressing the lid's tab inwards and up on the front of the machine with your thumb.



3 CLEANING INSTRUCTIONS

Wipe down the medication tray with a damp cloth.



4 LOADING YOUR MEDICATION



You will notice that there are six dosage ring templates to select from. Choose the ring that has the correct amount of doses per day for your medications. These doses go up to six-times per day. Place the appropriate ring for the medication regimen on the tray; fold tabs down to secure in pill compartment, prior to filling it, and use this as a guide as to where to place the pills.

Once the ring is in place, simply fill the slots with your medication. Note: It is normal, when your doses are less than 4 times a day, to have more than one day's worth of medication in each slot.

The refill frequency will depend upon the number of daily medications for example:

- > One time a day medication refills every 28 days
- > Two times a day medication refills every 14 days
- > Three times a day medication refills every 9 days
- > Four times a day medication refills every 7 days
- > Five times a day medication refills every 5 days
- > Six times a day medication refills every 4 days

Six Dosage ring templates

Load the pills in an anti-clockwise direction, do not leave any spaces. The device comes with 6 templates/dosing rings, for 1 to 6 doses per day. Use the correct template to aid loading. All of the templates assume medicines will be filled to start from a Monday. If you start on a different day, or you are doing 5 or 6 dosage alarms per day, you may need to modify, disregard, or create your own template.

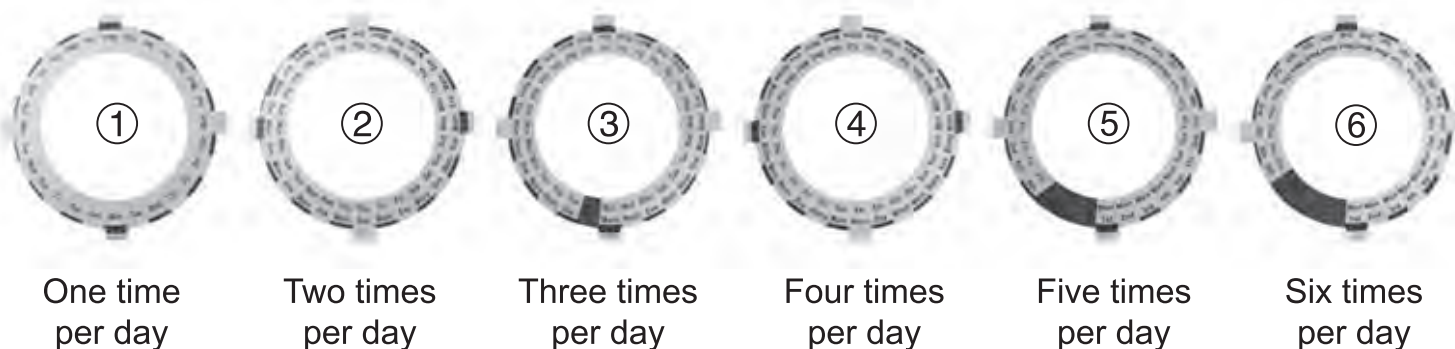
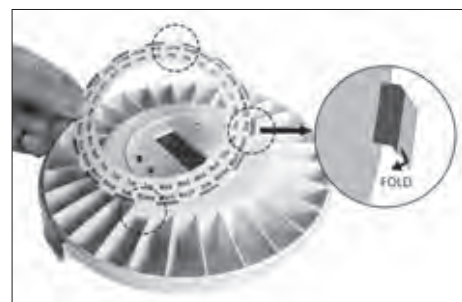

5 DISPLAY LAYOUT

The below figure describes the meanings of symbols on the LCD display:

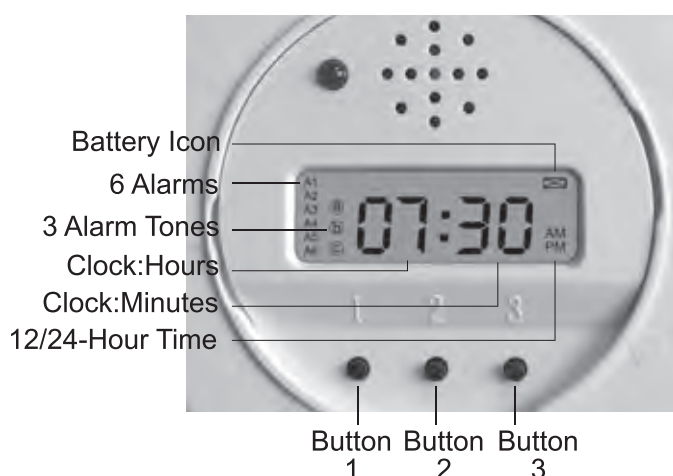

1. "A1~A6" Set up times of each alarm/reminder for medication events.

2. Button 1 is the "menu" button. A quick click allows access to setting alarm times for each medication event. Pressing the 1 button for 5 seconds will allow access to the clock settings.

3. Button 2 is the "scroll-down" button. A quick click to this button will place the Med-E-Lert in the "sleep mode" the LCD Screen will close.

4. Button 3 is the "scroll-up" button. A short click of button 3 will wake the Med-E-Lert .

If "ERR" is displayed on the LCD screen, the Med-E-Lert™ has become jammed. Open the Med-E-Lert™ and check the pill tray for obstructions. To reset the Med-E-Lert™, remove the batteries and place them back correctly.

6 12/24-HOUR TIME FORMATS



▲ Press and hold buttons 2 and 3 simultaneously.

The Med-E-Lert™ automatically defaults to a 24-hour format. The AM or PM symbol will appear on the right side of the display when the clock is in the 12-hour format. Choose 12- or 24-hour clock by pressing buttons 2 and 3.



24-hour format



12-hour format

7 SLEEP MODE & WAKE UP DISPENSER

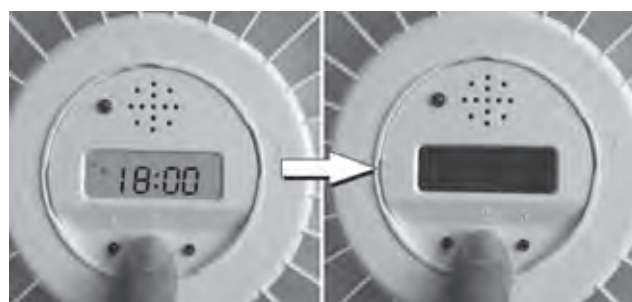

Press button 2 to put the Med-E-Lert™ into "sleep mode." After the Med-E-Lert™ goes into "sleep mode," it will shut down the screen to extend its battery life. Alarms will still operate in "sleep mode".

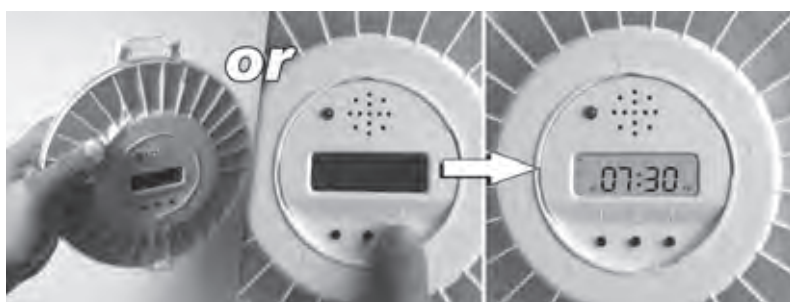

A quick press of button 3, or tipping the Med-E-Lert™ over as if dumping out pills can wake up the machine from "sleep mode."

8 SETTING UP THE CLOCK TIME

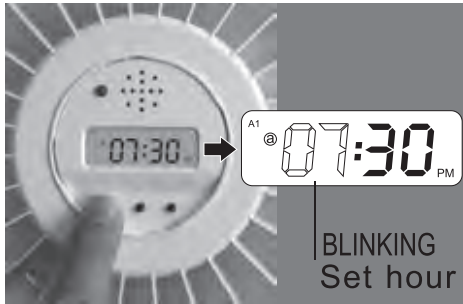

Hold down button 1 until the hour starts blinking.

Note: if you do not hold the button, it will go to the alarm settings.

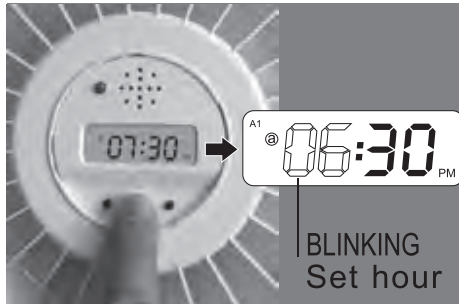

To scroll down the numbers press button 2. A quick press of button 2 will go back 1 hour. Hold down button 2 to scroll through more quickly.

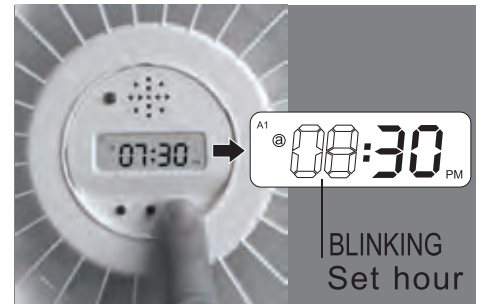

To scroll up the numbers press or hold button 3.



Once the desired hour is reached, quickly press button 1, the minutes will begin to flash. Click on button 2 to scroll down and button 3 to scroll up through the numbers until the correct minute is reached.

Press button 1 for 5 seconds to complete setting the clock.



TabTimer
helping to keep people on time

Med-E-Lert™



TabTimer
helping to keep people on time

9 TO SET UP YOUR ALARM



- ▲ (1) Press and release button 1 - the hours should flash.



- ▲ (2) Tap button 3 repeatedly until the correct hour is selected.



- ▲ (3) To go back an hour, if needed, tap button 2, until the correct hour is reached.



- ▲ (4) Once the hour is set, tap button 1 and the minutes will flash.



- ▲ (5) Tap button 3 repeatedly until the correct minutes are reached.



- ▲ (6) To go back a minute, if needed, tap button 2, until the correct time is reached.



- ◀ (7) Tap button 1 again to save the alarm time.
(8) Repeat sequence until the required alarms are set. Leave --:-- symbol if no alarm is required.
(9) When you are finished, tap button 1 until you no longer see the alarm symbol.

- (10) To cancel an alarm, first select the alarm, then press buttons 2 or 3 until you see the --:-- symbol.

Note: Once alarms and time is set and you're at the main menu, the colon between hours and minutes will continue to flash.

10 TONES



Press and hold buttons 1 and 3 to select your desired alarm tone. A, B, or C. Symbols A, B, or C should display. If it is blank then no tone will sound, just flashing light at alarm time.

To select an alarm tone, press and hold buttons 3 and 1 simultaneously. You will need to repeat this process each time to move on to the next tone. Quickly press button 1 once you've reached the desired alarm tone to return to the main screen.

11 HOW TO LOCK AND UNLOCK MED-E-LERT

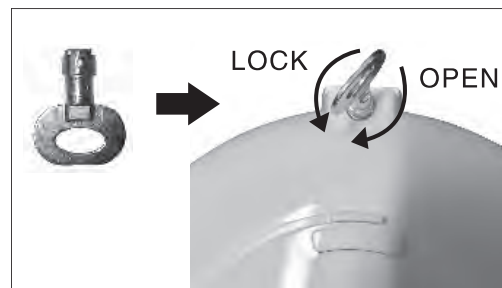

To LOCK - insert key, gently turn it to the left. Towards the 'L' ¼ turn only.

To OPEN - insert key, gently turn it to the right. Towards the 'O' ¼ turn only.

Do not overturn or lock will break.

12 HOW TO STOP ALARM



To stop an alarm and dispense the pills, pick up Med-E-Lert™ and tilt it over, catching the pills with a hand or suitable container. The alarm will stop. The alarm will continue for up to 30 minutes until the device is tipped.

13 LOW BATTERY ALERT & STANDBY WAKE UP

When the batteries are lower than 4.0V, the low battery icon will appear on the LCD screen and both the battery icon and LED will begin blinking. When the blinking LED and the low battery icon are visible, it's time to change all 4x 'AA' batteries with 4 new ones. The system will cease to work until all batteries are replaced.



If there is no operation for one minute, the Med-E-Lert™ will go into stand-by mode and the display will go blank to save battery life. Alarms will still operate in "sleep mode".

When replacing batteries we recommend standard alkaline batteries, Duracell or Energiser only. **DO NOT USE;** Rechargeable, Heavy Duty, Advanced, Ultra, Max, or Eco.

14 ATTENTION

(1) After 5 minutes of inactivity, and if it is not time for a programmed alarm, the system will go to "sleep" and shut down the display. The time and alarms will be saved. When it is time for a programmed alarm, the system will wake up, and alarms will operate as normal.

(2) If the pill dispenser is left upside-down for 1 minute, there will be a chirping sound coming from the Med-E-Lert™. The chirping sound will continue until the Med-E-Lert™ is up-righted. If it is time for an alarm and the Med-E-Lert™ remains upside-down, the full alarm will sound and the blinking red light will also be displayed. After the Med-E-Lert™ is up-righted to the correct position, the pill tray will rotate granting access to the medications. Once the dispensing slot is emptied, the scheduled alarm will stop.

(3) If "ERR" is displayed on the LCD screen, the Med-E-Lert™ has become jammed. Open the Med-E-Lert™ and check the pill tray and cog for obstructions. To reset the Med-E-Lert™, remove and reposition the tray, remove the batteries, and place them back correctly.

(4) If the device will not stop beeping this usually indicates that the batteries are low and need to be changed, or have become dislodged. Batteries should last approximately 6 months depending on how many and duration of alarms. When replacing batteries we recommend standard alkaline batteries, Duracell or Energiser only. **DO NOT USE;** Rechargeable, Heavy Duty, Advanced, Ultra, Max, or Eco. If your issue is not resolved by the above please call us.

(5) The lock has a tamper resistant feature, if the lock is over turned backwards and forwards, the wrong way, or someone attempts to break into the device, the lock WILL break. We cannot repair the lock if it is broken. A replacement device will be necessary. Breaking the lock will be caused by incorrect operation of the lock. THE LOCK IS NOT COVERED BY ANY REPLACEMENT WARRANTY. Please take care with the lock.

(6) **DISCLAIMER:** The Med-E-Lert™ Automatic Pill Dispenser is not a medical device and is not for use in the diagnosis of disease or other conditions, or in the cure, mitigation, treatment or prevention of disease. Med-E-Lert™ is designed as a medication aid only. Med-E-Lert™ is NOT a medication safe or vault, and it is not 100% tamperproof. With determination, a patient may be able to break into the device and access more medicine than intended. If there is any doubt a patient will have an uncontrollable urge to access more medicine than prescribed, please do not use this device. We have alternative devices if this is the case, please visit; www.TabTimer.com.au



TabTimer
helping to keep people on time

TabTimer Pty Ltd ABN 99 137 415 948



PO Box 7395
ALEXANDRIA NSW 2015 Australia



Call: 1300 TAB TIMER (1300 822 846)



Visit: www.TabTimer.com.au
email: info@tabtimer.com.au